

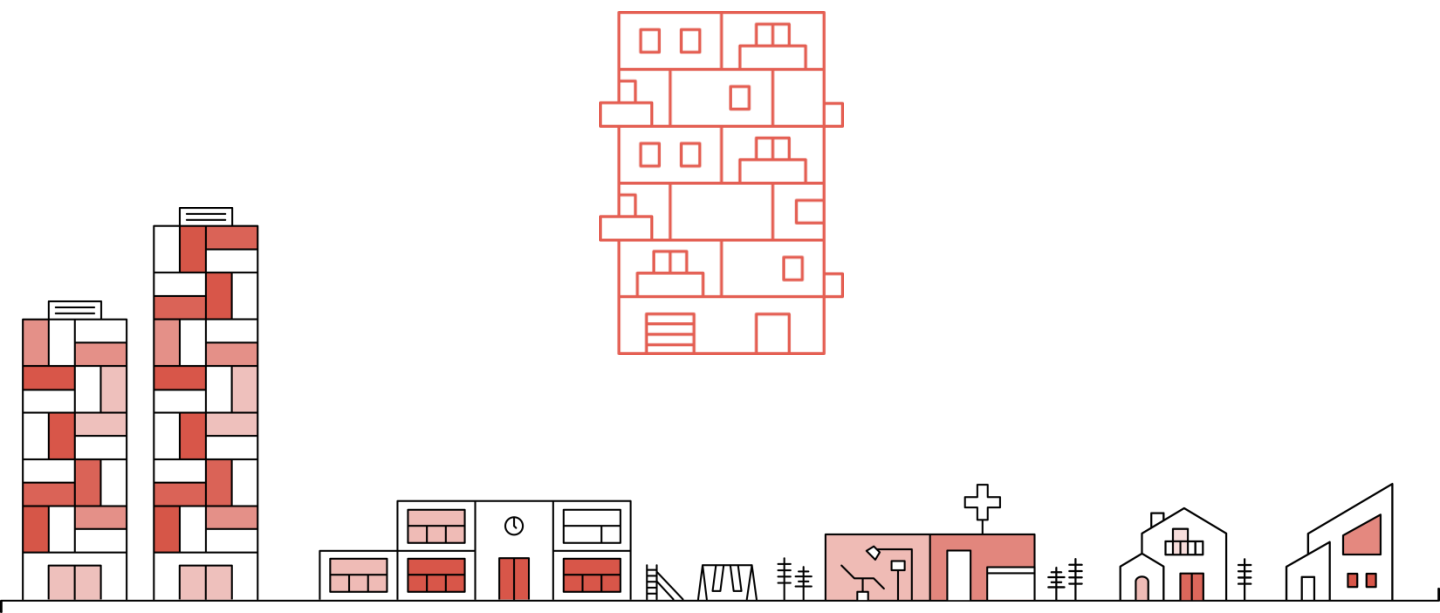

ZONING

In your apartment

Full air Conditioning installation



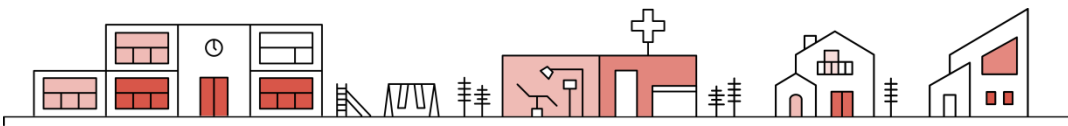

Zoning is the ultimate solution to problems with temperature discomfort caused by air conditioning systems with a single centralised thermostat.

Conventional centralised systems do not provide real comfort, because the ideal temperature in one room will not be the same as in others, due to geographic orientation (whether it is reached by the sun or not), the way in which the room is used and, of course, whether there is anyone in there or not.



In a **zoned** air conditioning system, **thermostats** and **control dampers** are installed in each of the areas that need conditioning, along with a **central control unit** to manage the entire system.

The **thermostats** measure the temperature in each room; the control unit processes the information it receives and then acts on the control dampers in the zone and on the cold and heat producing equipment, to create the temperature that the user wants at any time, all with the minimum consumption possible

The **communication buses** with the production machines and the **pressure regulating systems** in the air ducts are essential for an optimal installation..

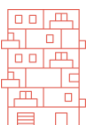

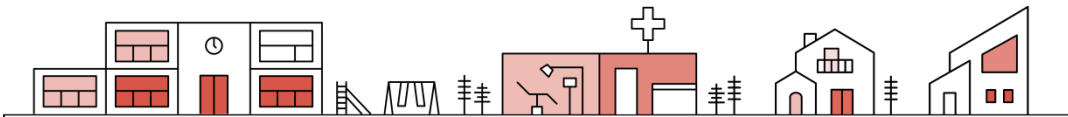

ZONING

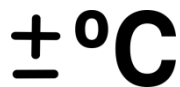

Control the temperature in each room independently .

Separately turn off and turn on in each zone.



Activate the ECONomic mode in temporarily unoccupied zones.

Program the start up and turn off times in each zone each week.



Block the thermostats to avoid unwanted manipulation

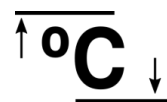

Limit the minimum and maximum temperature in each zone.

MASTER

MASTER Control the air conditioning equipment from the MASTER thermostat using

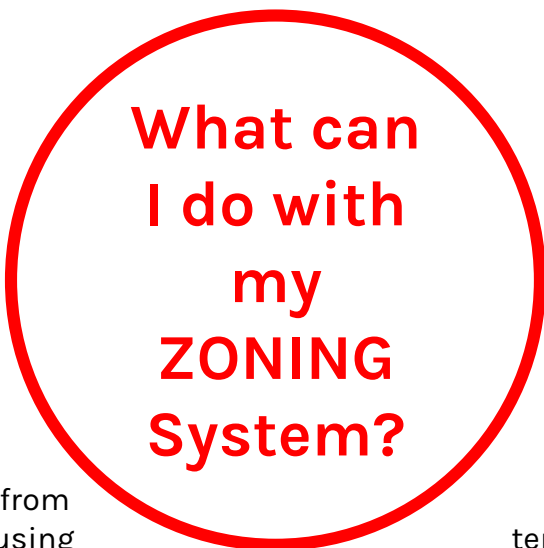

Set the parameters of the system to select the temperature adjustments in each zone and adapt them to your needs.

Fle*❌*iFan

Thanks to the fan speed control system, you can adapt the volume of air flow of the machine based on zones where there is more or less demand and the nature of your particular installation.

Integrate your ZONING equipment with other **DOMOTIC** devices.

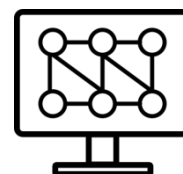

Using Madel's **CLOUD** interface. You will be able to remotely control your system and add other functionalities.



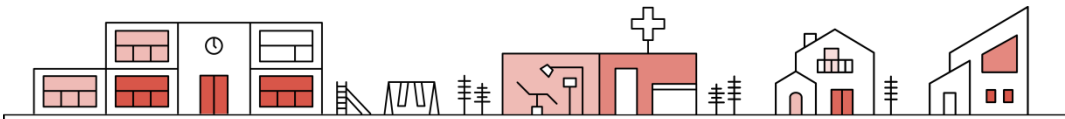

Qué necesitas para tu sistema de zonas ?

01 A **CENTRAL CONTROL STATION** and a machine control interface adapted to the air conditioning equipment.



ZITY Control CENTRAL



INTERFACE Machine



ZOE-RC
Radio Thermostat



ZEBRA
Cable Thermostat

02 See which independent zones you want to control and select one **THERMOSTAT** for each of them.

03 A **CENTRAL CONTROL STATION** and a machine control interface adapted to the air conditioning equipment



ZP-AZ:
Damper for grilles



ZC:
damper for round duct



ZQ:
Damper for rectangular duct.

04 Evaluate whether you need a **PRESSURE CONTROL**, if the minimum flow from the machine exceeds the flow of the smallest room.



ZS / ZG / ZK
Mechanical pressure controls



KBY
Electronic pressure controls

05 Finally, select whether you wish to control the equipment through the remote control **INTERFACES**.



06 Now you have everything you need to enjoy a Zoning System

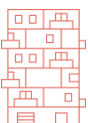

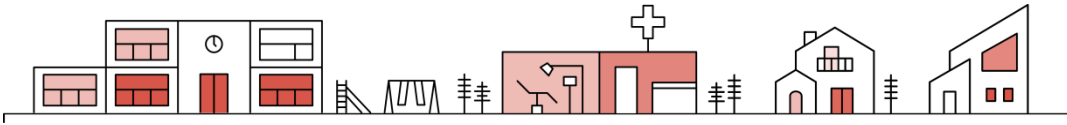

Home S1: Air Conditioning through direct expansion

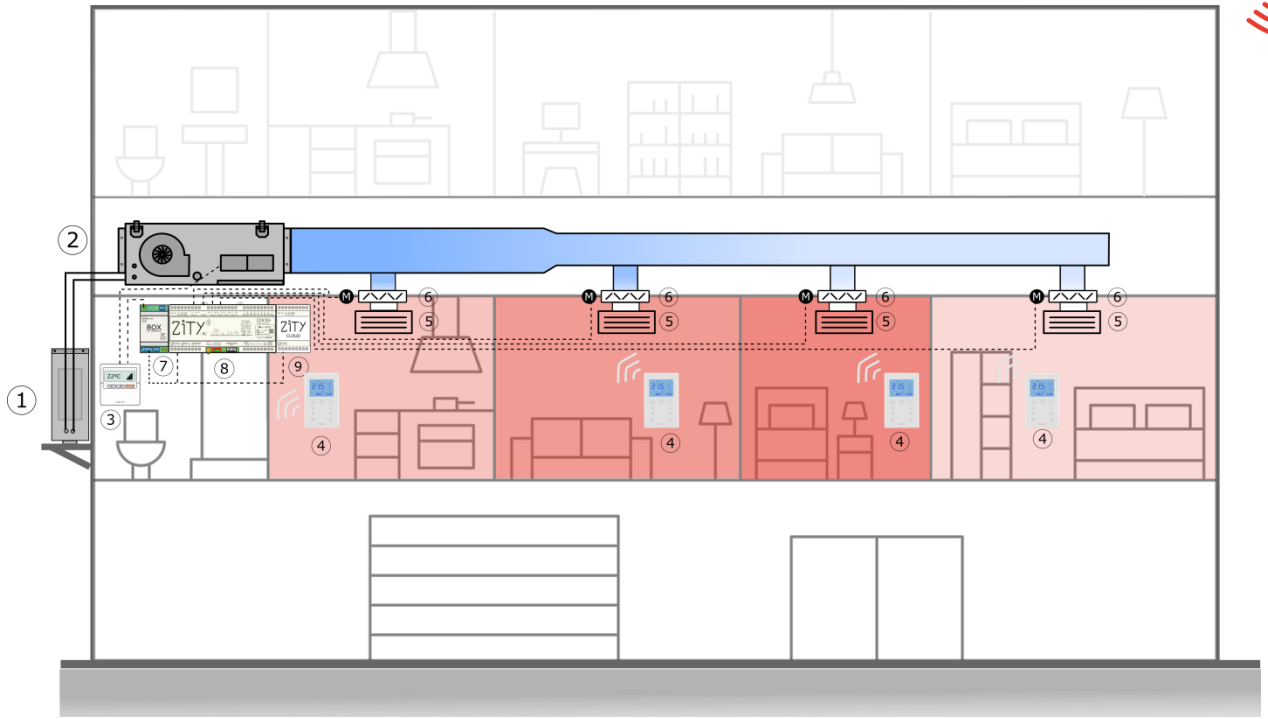

- | | | | |
|---|-----------------------------|---|--------------------------------------|
| 1 | Unidad exterior A/C | 6 | Motorised Zone Damper |
| 2 | Unidad interior A/C | 7 | A/C Machine Communication Interface. |
| 3 | Mando Unidad A/C | 8 | ZITY Central Control Unit |
| 4 | ZOE Cabling Zone Thermostat | 9 | Communication Interface NETBOX |
| 5 | Supply grilles | | |

WIRING DIAGRAM

For standard 4-zone installation. Radio Thermostats.

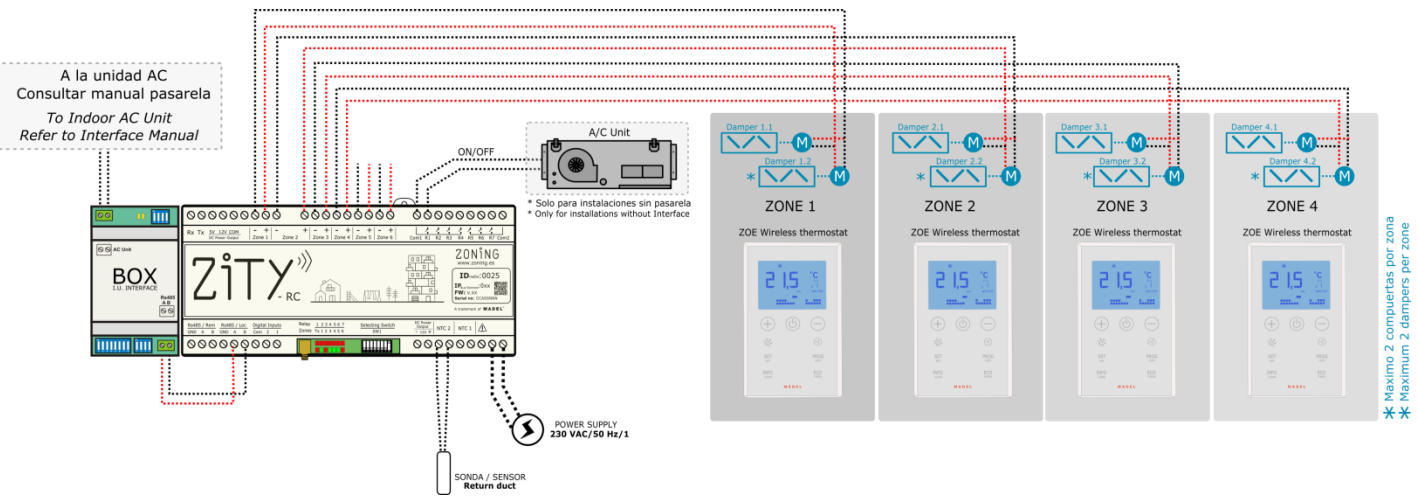

* Máximo 2 compuertas por zona
* Maximum 2 dampers per zone

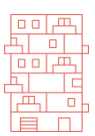

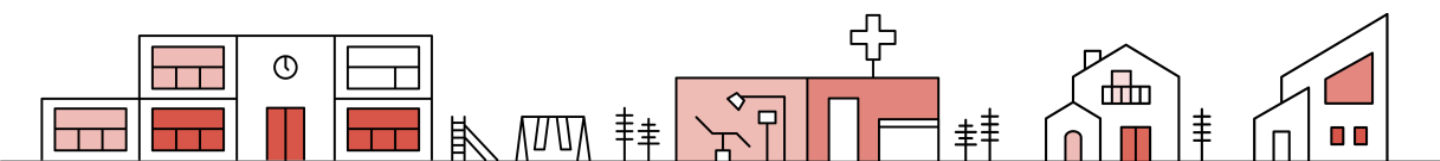

ZONiNG

P.O. BOX 5
08540 Centelles (Barcelona)
T +34 93 889 80 91
www.zoning.es



ZONiNG is a brand of **MADEL**